

BETACHEK[®] G5

POCKET TESTING GUIDE

Please read the User's Manual carefully and completely before performing the first measurement.



1. Battery cover (on underside)
2. Finger slot for removing memory card (on under side)
3. Memory recall button
4. Memory card slot
5. Test strip guide
6. Display
7. Power button
8. Memory recall button

Getting started

Before using your meter for the first time, pull the plastic tab out of the battery compartment as shown on User's Guide page 3

Coding your meter



Each pack of test strips comes with a memory card that must be inserted into the meter before any tests are performed.

In addition to recording your result, the memory card programs the meter to read the test strips accurately.

Each memory card has a three-digit number printed on it called a code number. The code number is also printed on the test strip container. Before you insert the memory card the meter will display three bars and flash the word CODE.



Step 1: Insert memory card

Take the memory card from the pack of test strips and insert it into the meter.

The meter will sound a chime when the card is correctly inserted and the coding is completed

Step 2: Check the code number

The meter will then display a three-digit code number. Check that the number displayed matches the number printed on the container of the test strips and memory card.

Memory



The meter has a capacity of 250 results. When full, the oldest results are deleted to make room for new ones. This is a "first in, first out" system which means results are not stored permanently.

Conversely, the memory card supplied with each pack of test strips provides a permanent record of results from a single pack of strips.

Performing a test

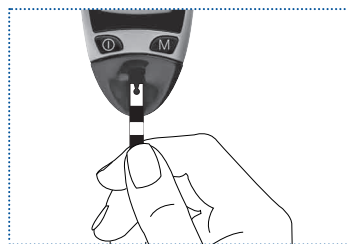

A test strip may be inserted either before or after turning the meter on.

Note: Hold the strip close to the middle AS SHOWN.

Caution: Insert the strip as far as it will go into the meter.

DO NOT bend or kink the strip as this will damage it.

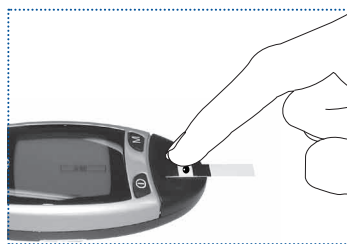

Apply blood with the strip in the meter.

Apply a drop of blood to the centre of the square mesh area. It is OK to touch the mesh. A small drop (1- 2µl) is all that is needed to quickly cover the test zone. The test zone must be completely covered, otherwise

you may obtain a false reading.

When a blood drop has been applied, the meter will give a beep and commence measuring. Do not move the test strip as this will lead to an incorrect result. The meter will display the result with time and date. The result will automatically be saved to the meter and card memory.



The G5 meter measures blood glucose between 0.5 – 25.5mmol/L (9-460mg/dL). Values outside this range are reported as 'Lo' or 'Hi'.

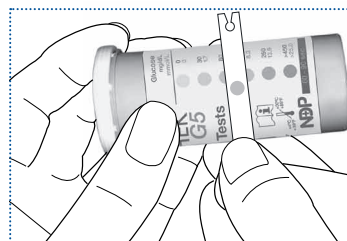

Comparing colour

Turn the test strip over to view the round window on the back. On the test strip bottle label, you will see a colour chart with glycemic levels next to colour spots.

Find the glycemic level closest to your meter result.

Compare that glycemic level's colour spot on the label to the window colour on your test strip. This should be done between 30 and 60 seconds after applying blood to the test strip.

These colours should approximately match. If they do not, then repeat the test. If the colours approximately match then the result is confirmed.

Meter maintenance

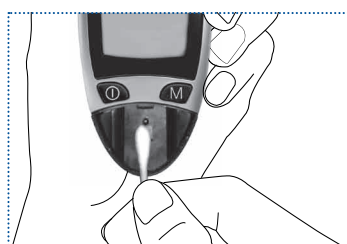

The strip guide may be removed for cleaning. Slide it off and rinse it with cold soapy water. Check it is clean on both sides and then dry it.

The optics area under the strip guide can be cleaned using a cotton tip or soft damp cloth. Be careful not to get water into the meter!

Key to symbols



Low battery warning

When this symbol appears the meter will still perform another 50 tests. You should replace the batteries.



Ambient temperature

The ambient temperature is/was outside the recommended range 18-35°C (64-95°F). The result will be stored in memory with this symbol. Do not make treatment decisions based on this result.



Apply blood

Apply blood to the test strip.



Testing underway

Test is underway, await result.



Insert strip

When this symbol flashes, insert a test strip into the meter.

Mem

Memory recall

Memory result recalled.

Key to error messages

E-0

EMC error

EMC error (electromagnetic field) move away from possible source e.g. mobile phone, microwave.

E-1

Flat battery

Flat battery, no test may be performed.

E-2

Calibration error

Out of calibration, return to supplier.

E-3

Check test strip

Damaged or used test strip or strip not fully inserted or the measurement optics are dirty. See section Caring for the G5 meter - user's manual page 21

E-4

Memory card full

Replace with a new memory card from a fresh pack of test strips.

Note: Although not displayed, the result will be stored in the meter memory.

E-5

Too much light

Too much ambient light or strip removed during test. Move out of direct sunlight.

E-7

Blood applied too early

Blood applied too early, repeat the test and wait for the blood drop icon.

E-8

Test strip removed

Test strip removed during testing, repeat the test and leave test strip in the meter until the test is completed.

E-9

Faulty test strip

Faulty test strip. Check that you have stored and handled the test strips as instructed in the package insert.

Check memory card

Memory card not properly inserted or has a fault.

E-C

Memory card failure

Memory card cannot be read. Remove your card and reinsert. If the problem persists, you cannot use the card or test strips.

ttt

Incorrect temperature

Temperature outside permissible range. Tests cannot be performed outside permitted limits 5-45°C (41 - 113°F)

Betachek Test Strips:



National Diagnostic Products
Sydney, NSW, 2065
Australia



Welkang Ltd
29 Harley St.
London W1G 9QR, UK

Date Issued: June 2007
BG5MKEG0607

www.betachek.com

BETACHEK[®]

G5

Blood glucose monitor
POCKET TESTING GUIDE